

# CONSORT

ARCHITECTURAL HARDWARE

UNITED KINGDOM

UAE

QATAR

KSA

SOUTH AFRICA

**Item Code:** RP120L.S  
**Description:** Acoustic and Smoke Seal.

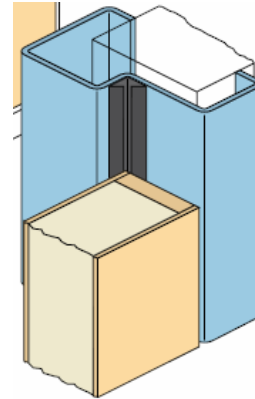
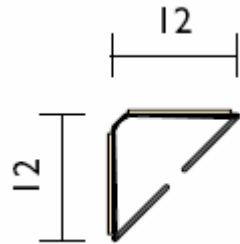

### Description

**RP120** is a co-extruded PVS, acoustic and smoke 'Batwing' seal Black Color For High Single Doors. Discreetly located in the protected corners of rebated timber or steel door frames. RP120 is suitable for new and retrofit applications.

**Location:** Around rebated frames of single or double butt hinged doors and windows.  
**Min/Max:** Gap 3mm to 5.5mm.  
**Seal Sizes:** Available in door set sizes.  
**Size Material:** Rigid and Flexible flame retardant PVC, with an aggressive self-adhesive backing tape on both sides of the rigid carrier (black).  
**Fixing Method:** Self adhesive  
**Note:** Contact surface must be clean, smooth and if painted, well cured.  
**Used in conjunction:** Raven door bottom seals, threshold plates and astragals.  
**Approved:** on fire rated doors up to FRL & FRR-/240/30 and FD240  
**Smoke Tested:** to AS 1530.7, ISO 5925-1 & EN 1634-3 like BS 476 section 31.1. Meets smoke leakage rates specified in AS 6905 & EN 13501-2 "Sa' ;'S

**Manufacturer:** Raven  
**Supplier:** Consort  
**Website:** [www.consort-hw.com](http://www.consort-hw.com)

**Contact Details:** **DUBAI**  
 Consort Middle East LLC  
 PO Box 19186 Dubai UAE  
**TEL:** 04 446 0900  
**FAX:** 04 446 0999  
**email:** [info@consortme.ae](mailto:info@consortme.ae)

**UNITED KINGDOM**  
 Consort Architectural Hardware Limited  
 29/31 Lower Loveday St. Birmingham , B19 3SB –UK  
 +44(0) 121 359 8189  
 +44(0) 121 359 5172  
[info@consort-hw.com](mailto:info@consort-hw.com)