

A Elevation
Door Detail (FD 60 Mins.) 1:10 @ A1

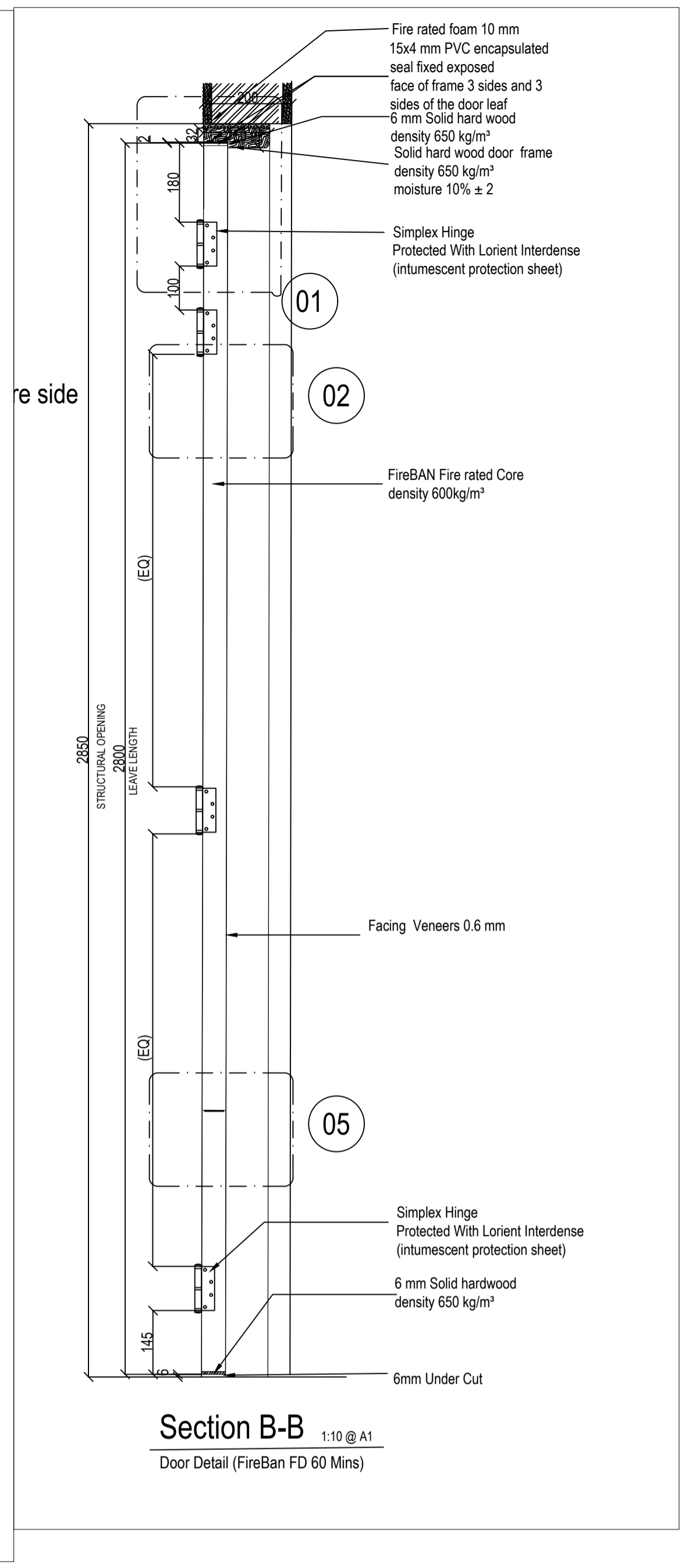

Section B-B
Door Detail (FireBan FD 60 Mins) 1:10 @ A1

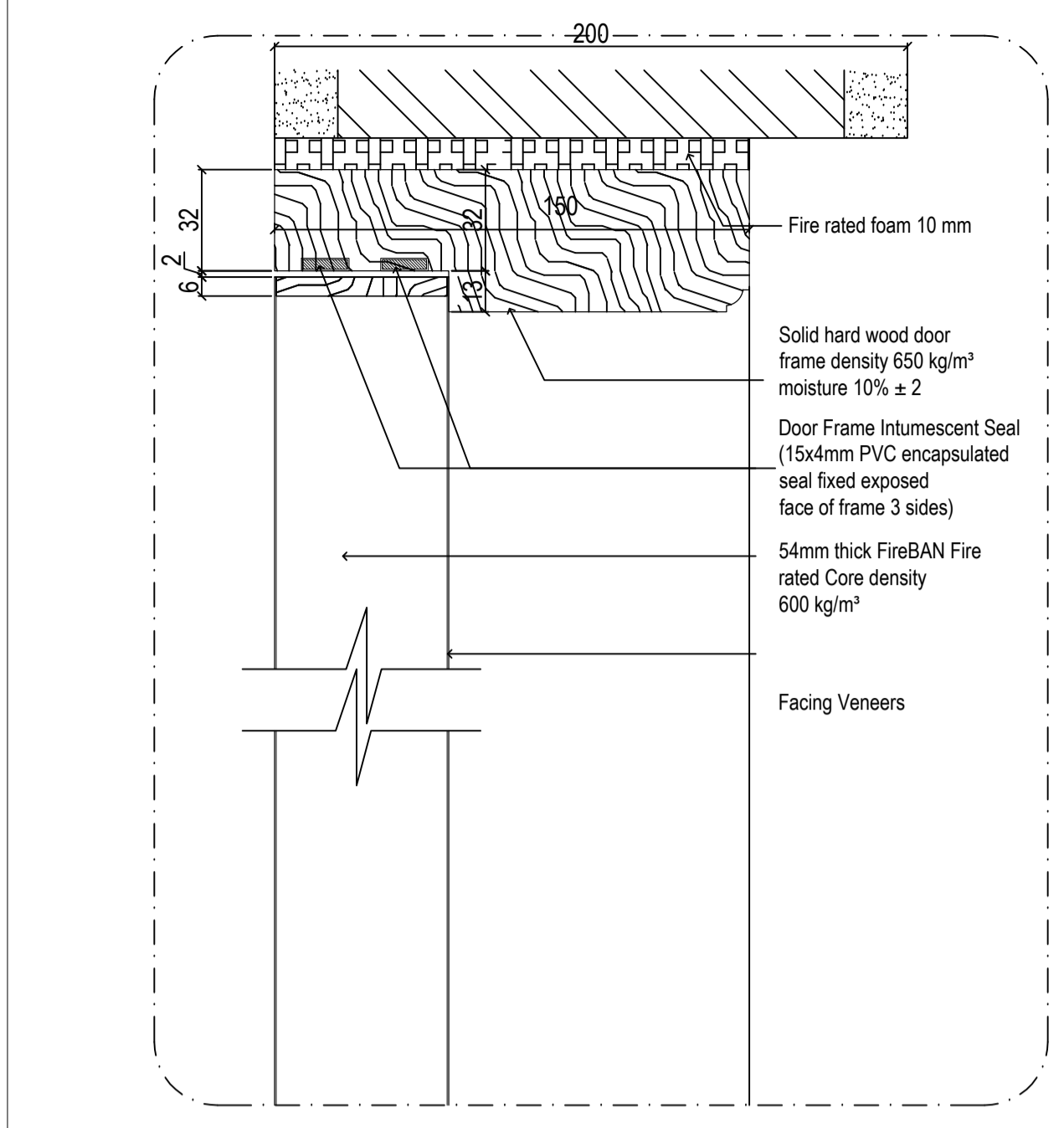

Detail 01
1:2 @ A1

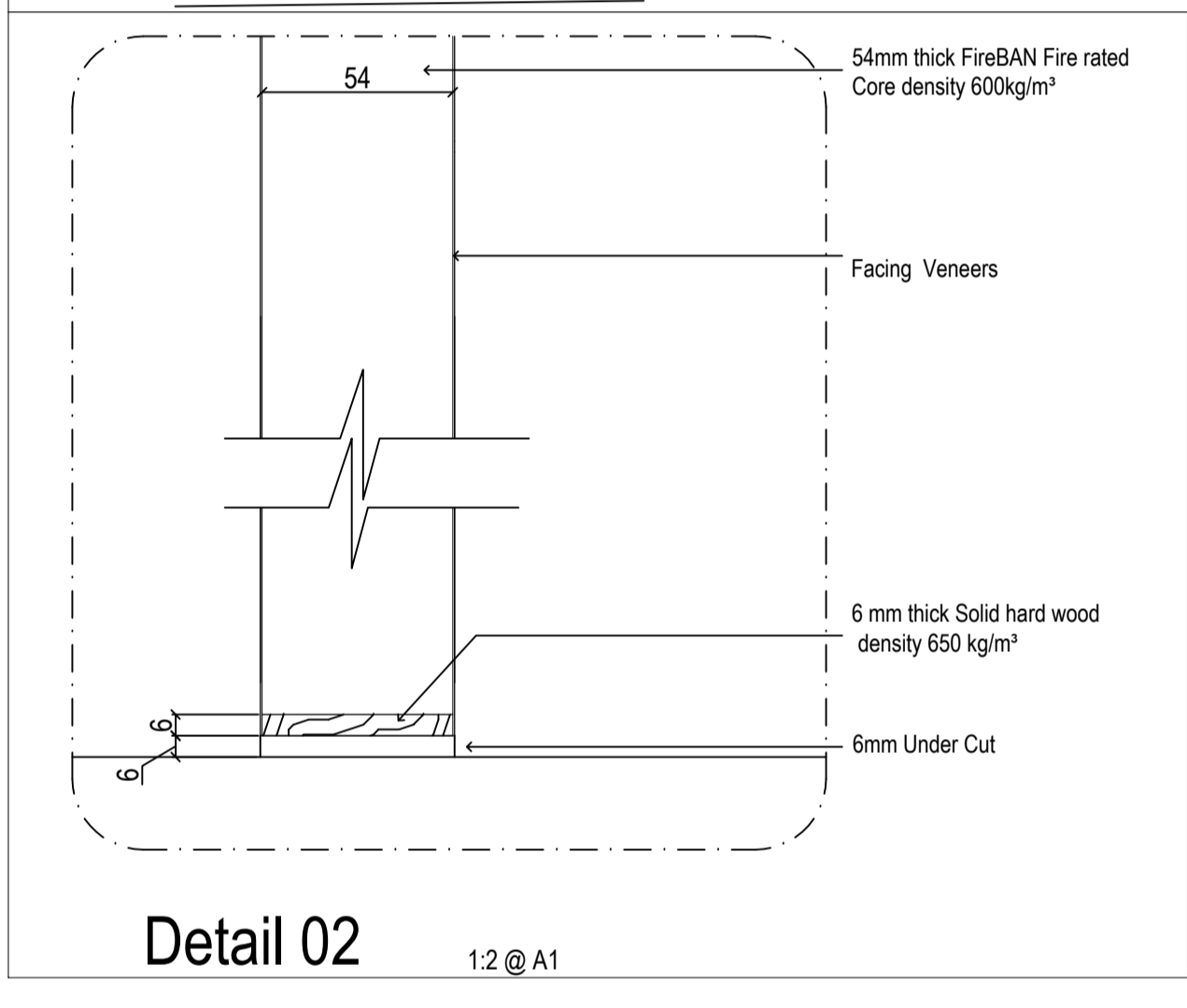

Detail 02
1:2 @ A1

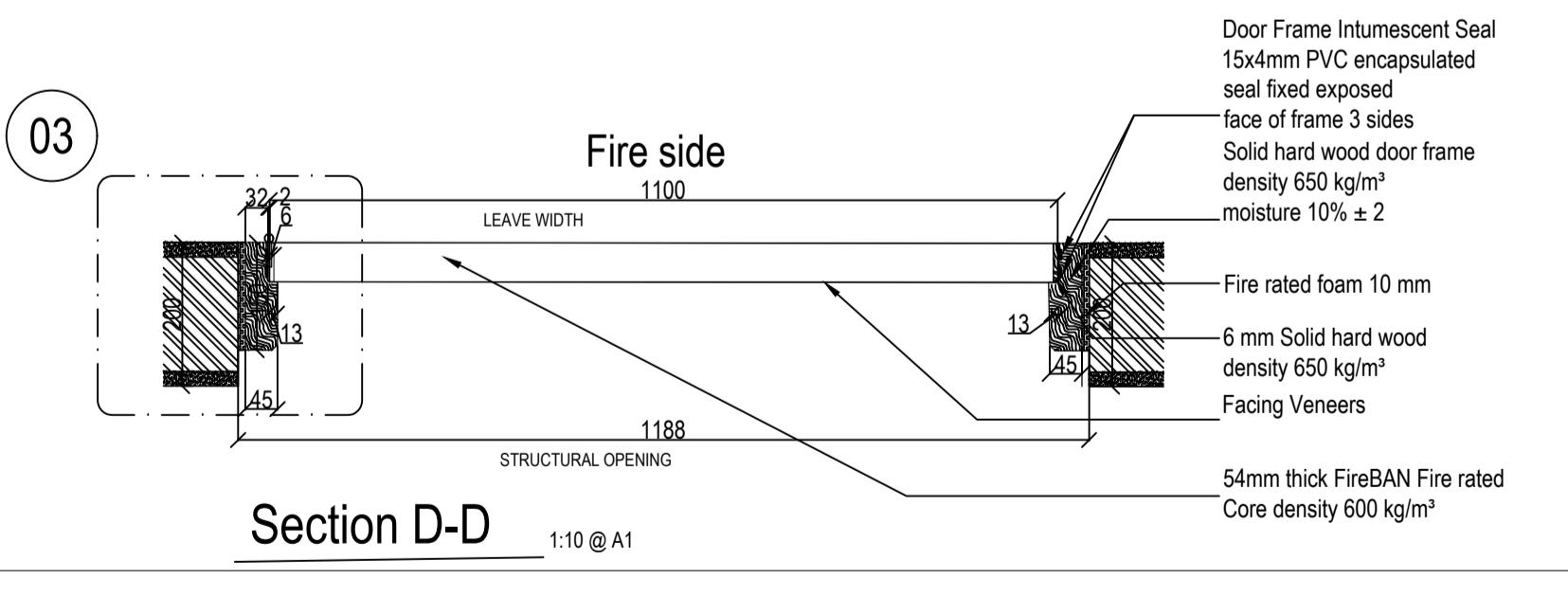

Section D-D
1:10 @ A1

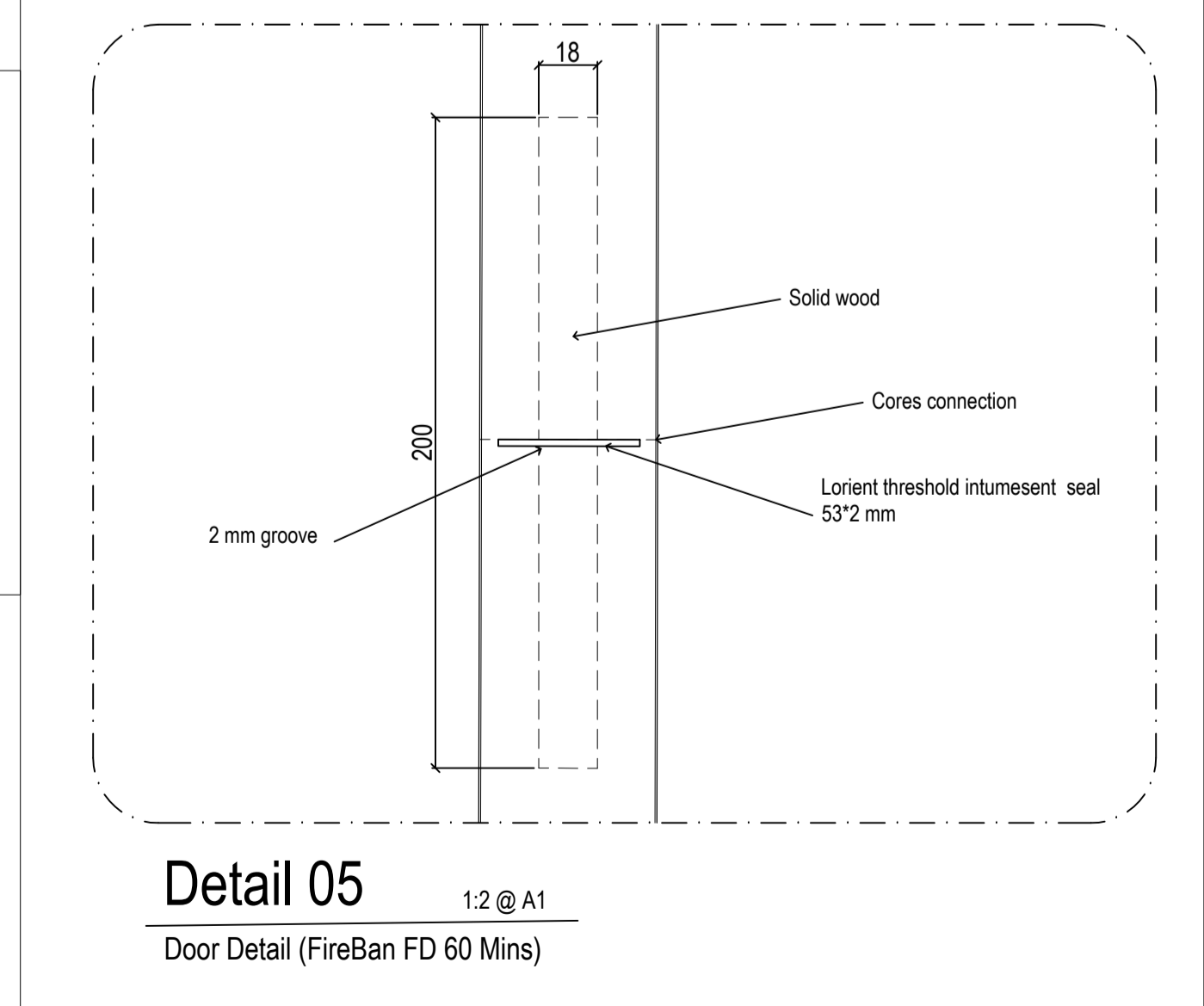

Detail 05
Door Detail (FireBan FD 60 Mins) 1:2 @ A1

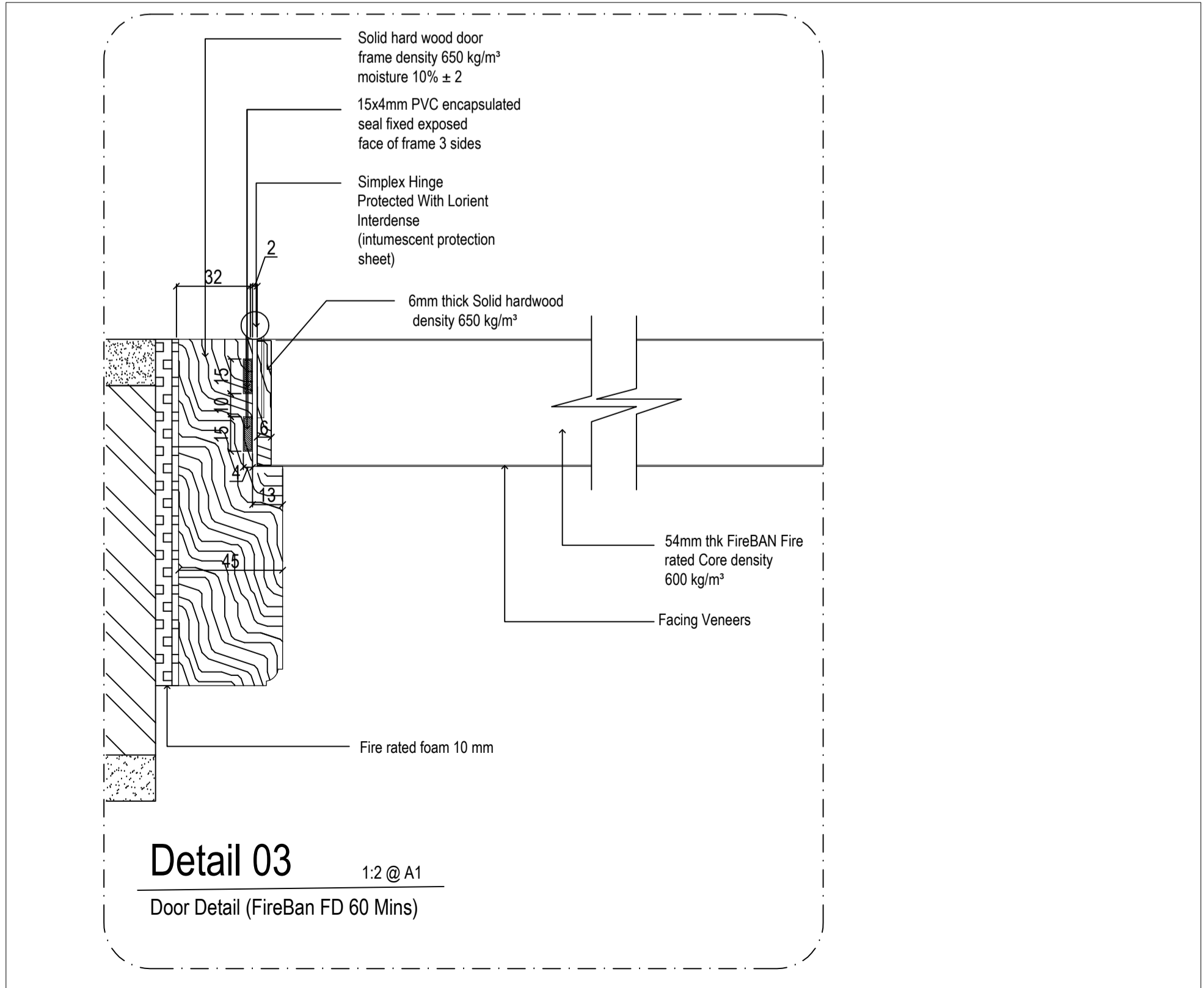

Detail 03
Door Detail (FireBan FD 60 Mins) 1:2 @ A1

GENERAL NOTE:
1. ALL DIMENSIONS ARE IN MILLIMETERS & LEVELS ARE IN METERS UNLESS NOTED OTHERWISE.
2. ALL MEASUREMENTS ARE PER SITE CONDITION

SHOP DRAWING APPROVAL STATUS

A APPROVED B APPROVED AS NOTED
C REVISE AND RESUBMIT D NOT APPROVED

DISCIPLINE	ARCHITECT	CIVIL / STRUCTURAL ENGINEER	MECHANICAL / PLUMBING ENGINEER	ELECTRICAL ENGINEER	MEDICAL EQUIPMENT ENGINEER	OTHERS
NAME INITIALS						
SIGNATURE						
DATE						

54mm Fire Door FD60 Single Acting Single Door



REV	DATE	DESCRIPTION	DRAWN	CHKD
REVISIONS				

- GENERAL NOTES**
- Note 1 : Frame material - Hardwood ≥ 650 kg/m³ Density @ 10% m/c ± 2%
 - Note 2 : Lipping material - Hard wood ≥ 650 kg/m³ Density @ 10% M/C ± 2%
 - Note 3 : Under cut of door standardized for 6mm.
 - Note 4 : Intumescent seal can be fitted on the frame 3 sides for fire rated doors. 2 nos 15x4mm. Approved Intumescent PVC pyroplex Brand
 - Note 5 : Finish can be Paint, Veneers & PVC, Plastic -Laminates, Decorative Paper (non metallic foil)
 - Note 6 : Fixing method for door leaf and frame using PU glue
 - Note 7 : Glue : material: polyurethane adhesive /brand name fevicol 1K, PUR adhesive
 - Note 8 : The intumescent protection sheet for hinges should be Mono ammonium phosphate dimension 30 X 101X 2 mm

DRAWN BY: LD	JOB No.:	DATE: 02/02/2016
CHECKED BY:	SCALE:	SHEET SIZE: A1
SHOP DRG. No.:	REVISION No.:	