

### Mortise Sash Lock

Locks for Interior and Exterior Doors for Public & Commercial Building.

#### Features

- Mortise lock can be operated from both sides by lever handles to withdraw the latch.
- Lockcase dimension according to DIN 18251 closed case with sleeves, silver electro zinc coated finish and lockcase prepared for standard fittings.
- Security Stainless Steel dead bolt with hardened anti-saw protection, 20mm dead bolt throw (double turn of key or cylinder turn)
- Latchbolt, Forend and strike plates made of Satin Stainless Steel 1.4301/ AISI304.
- Suitable for sprung and most unsprung lever handles.
- 8mm smooth follower, square spindle gripping feature.
- Smooth latch profile. Handing can be reversed quickly on site.

#### Standard and Certification

- **Quality & Performance:** Successfully tested to all the requirements of BS EN 12634-1:2008 and EN12209:2003/AC:2006 for locks & latches.
- **CE Marked:** Declaration of conformity available upon request
- **Fire Safety:** Assessed for use on 30 min & 60 min timber fire doors and 120 min. hours on steel doors. Intumescent pack to be applied for higher fire rating on timber doors, in order to achieve compliance to the European Fire Test Standard.
- **Conformity Statement:** This product meets the European Standard and dimensional recommendations BS8300:2009 & EN12209:2003 and approved of Document "M".



#### Classification Code

3 H 9 1 0 G 2 B C 3 0

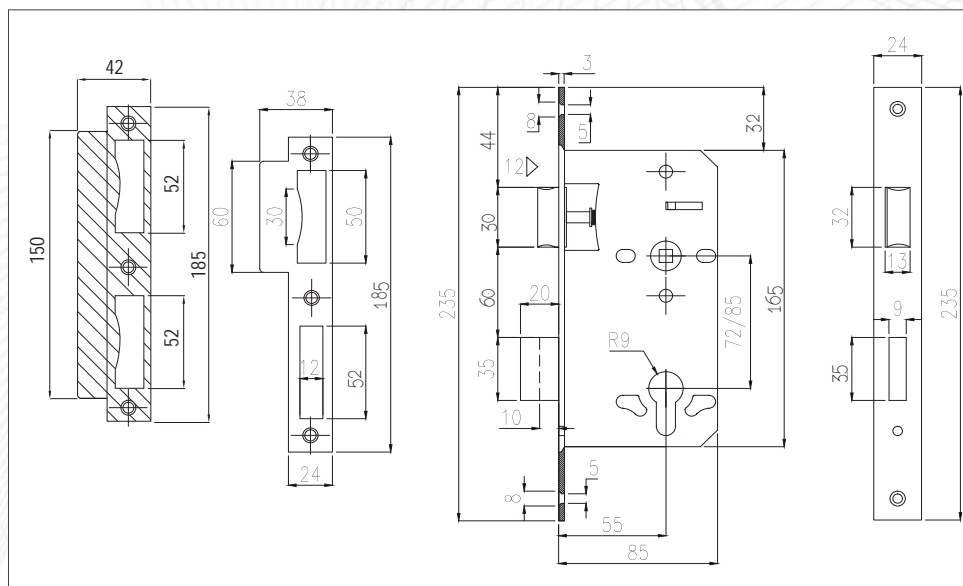

Item Code	Backset	C-T-C
884572Z	45	72
885072Z	50	72
885572Z	55	72
886072Z	60	72
886572Z	65	72
887072Z	70	72
884585Z	45	85
885085Z	50	85
885585Z	55	85
886085Z	60	85
887085Z	70	85

#### FINISHES



### Mortise Night Latch Lock with a Special Spindle

Locks for Interior and Exterior Doors for Public & Commercial Building.

#### Features

- The night latch function is operated using a half set of lever on the inside to retract the latch bolt simultaneously.
- The single cylinder operates from outside with a single turn of key to retract the latchbolt.
- Lockcase dimension according to DIN 18251 closed case with sleeves, silver electro zinc coated finish and lockcase prepared for standard fittings.
- Latch bolt, Forend and strike plates made of Satin Stainless Steel 1.4301/AISI304.
- Suitable for sprung and most unsprung lever handles.
- 8mm smooth follower, square spindle gripping feature.
- Smooth latch profile, quick reversible without removal of case cover on site handling.



#### Classification Code

3 H 9 1 0 G 2 B 0 3 0

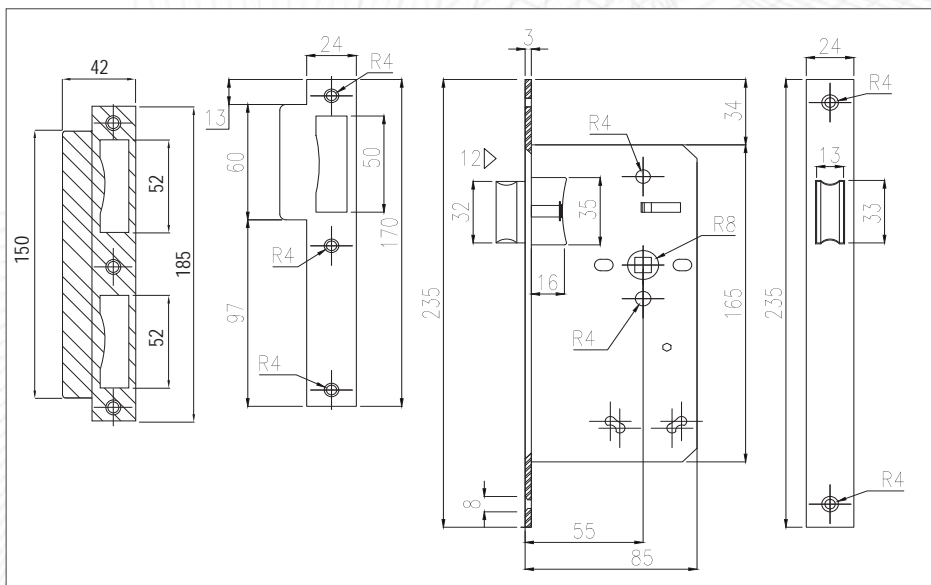

Item Code	Backset	C-T-C
884572ZN	45	72
885072ZN	50	72
885572ZN	55	72
886072ZN	60	72
886572ZN	65	72
887072ZN	70	72
884585ZN	45	85
885085ZN	50	85
885085ZN	55	85
886085ZN	60	85
887085ZN	70	85

#### FINISHES



### Anti-Panic Escape Sash Lock

Locks for Interior and Exterior Doors for Public & Commercial Building.

#### Features

- Latch bolt operated by lever handle from either side unless outside is made inoperative by key outside or by turning lever handle inside retract latch bolt and dead bolt. Inside lever is always free for immediate egress.
- Lockcase dimension according to DIN 18251 closed case with sleeves, silver electro zinc coated finish and lockcase prepared for standard fittings.
- Security Stainless Steel dead bolt with hardened anti-saw protection, 20mm dead bolt throw (single turn of key or cylinder turn).
- Latch bolt, Forend and strike plates made of Satin Stainless Steel 1.4301/AISI304.
- Suitable for sprung and most unsprung lever handles.
- 8mm square split follower, with anti-panic function, free egress from inside.
- Smooth latch profile, quick reversible without removal of case cover on site handling. Just pull the snib upward and rotate 180° to change the direction.



EN179

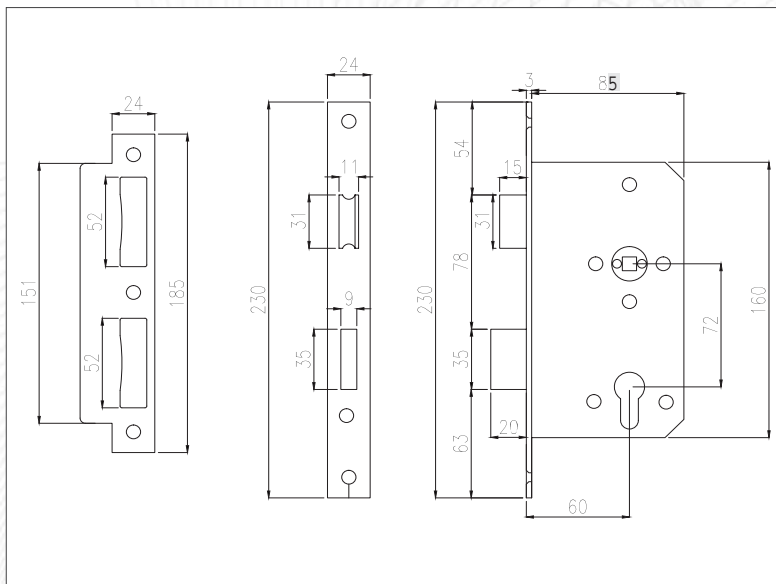

Item Code	Backset	C-T-C
886072ZAPN	60	72
886085ZAPN	60	85

#### FINISHES

